

Office series USB version
user's manual

In The Box:

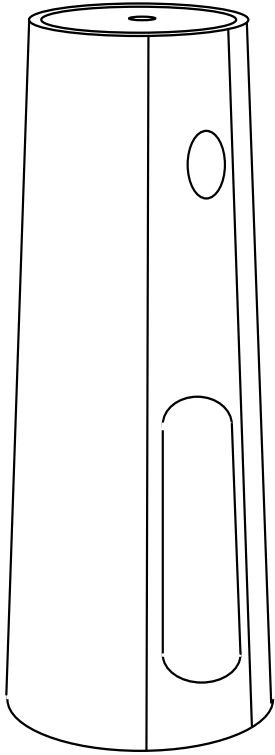

Team Free x 1

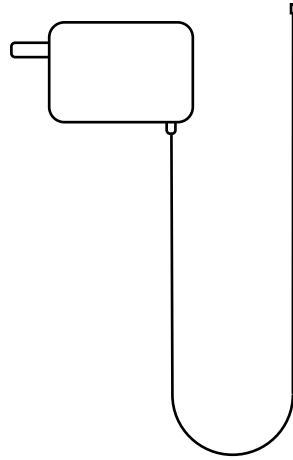

Power Adapter X 1

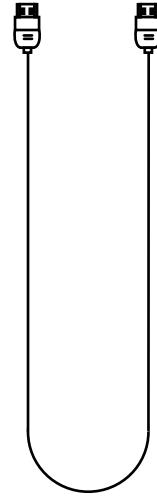

HDMI Cable X 2

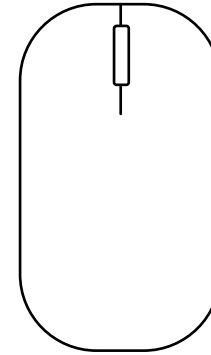

Wireless mouse X 1

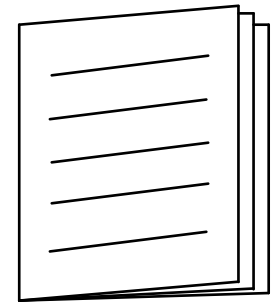

Quick Start Guide X 1

Product structure :

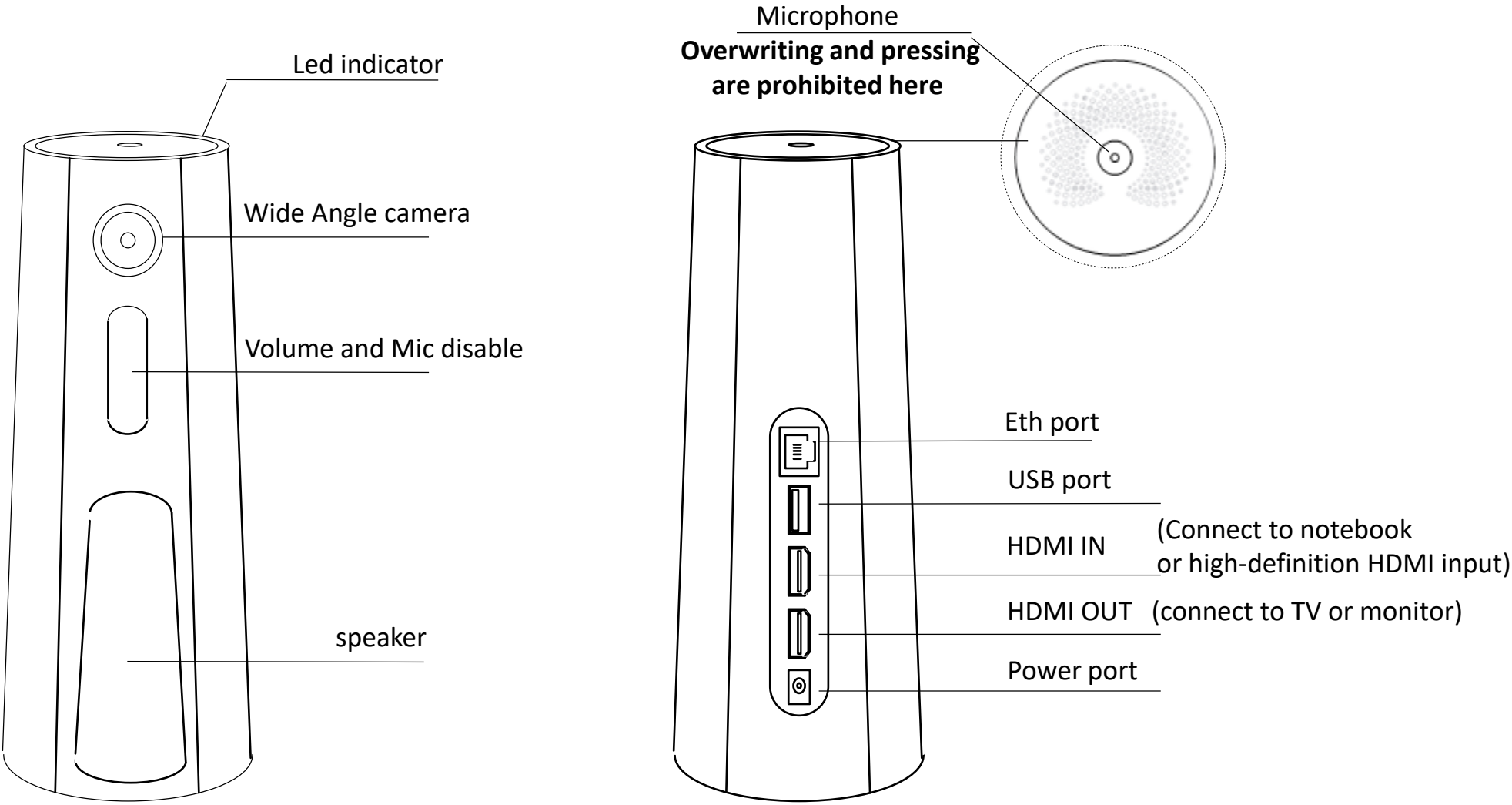

Note: The device has no power switch. It will turn on when connected to a power source and shuts down after disconnection

USB version – Device connection:

1 Power Connection

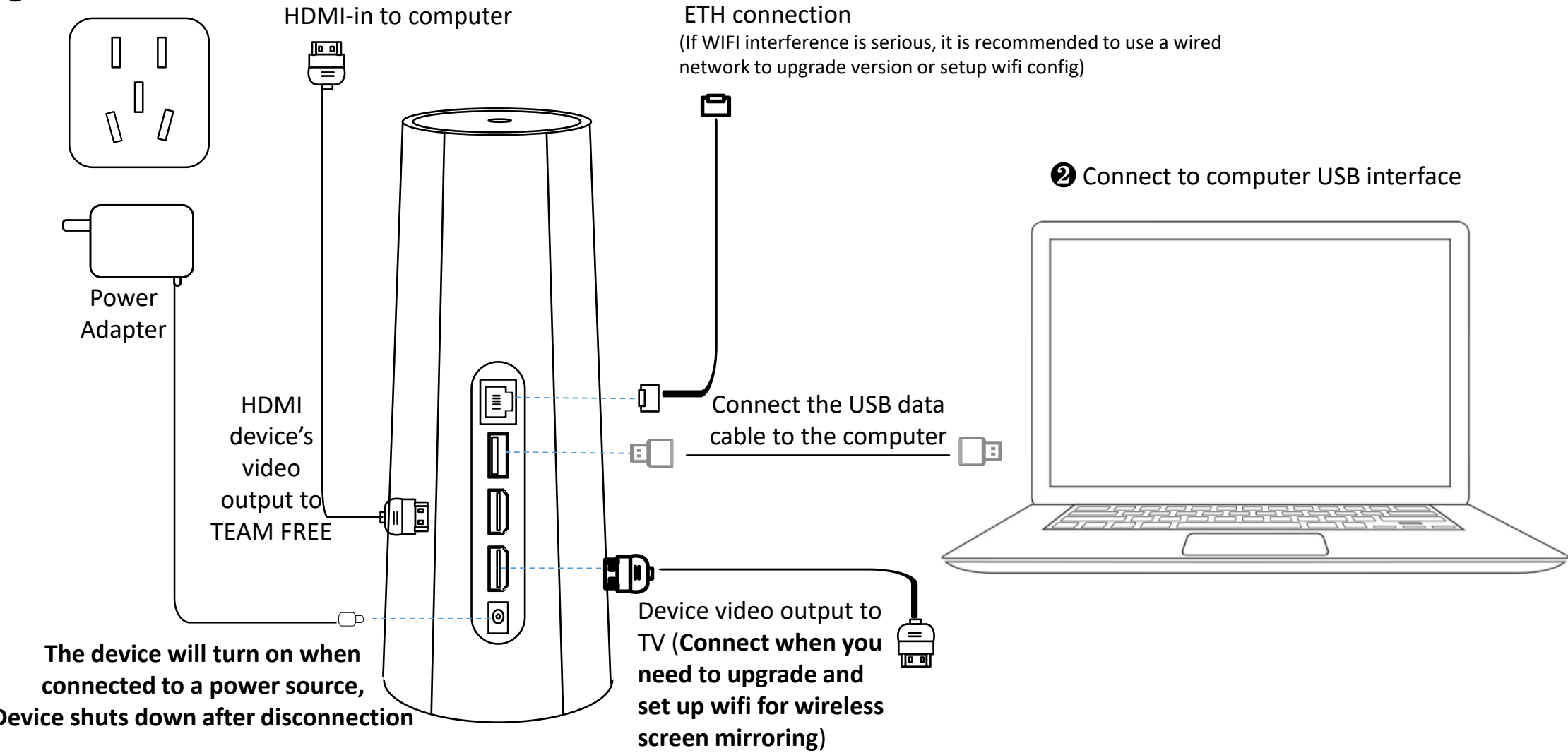

Note: It is recommended that the USB cable be connected from the device to the computer first, and then powered on. The computer will have a high success rate in identifying the USB device and will not fail to recognize the device.

USB version -- HDMI-out display content in USB working mode

main menu

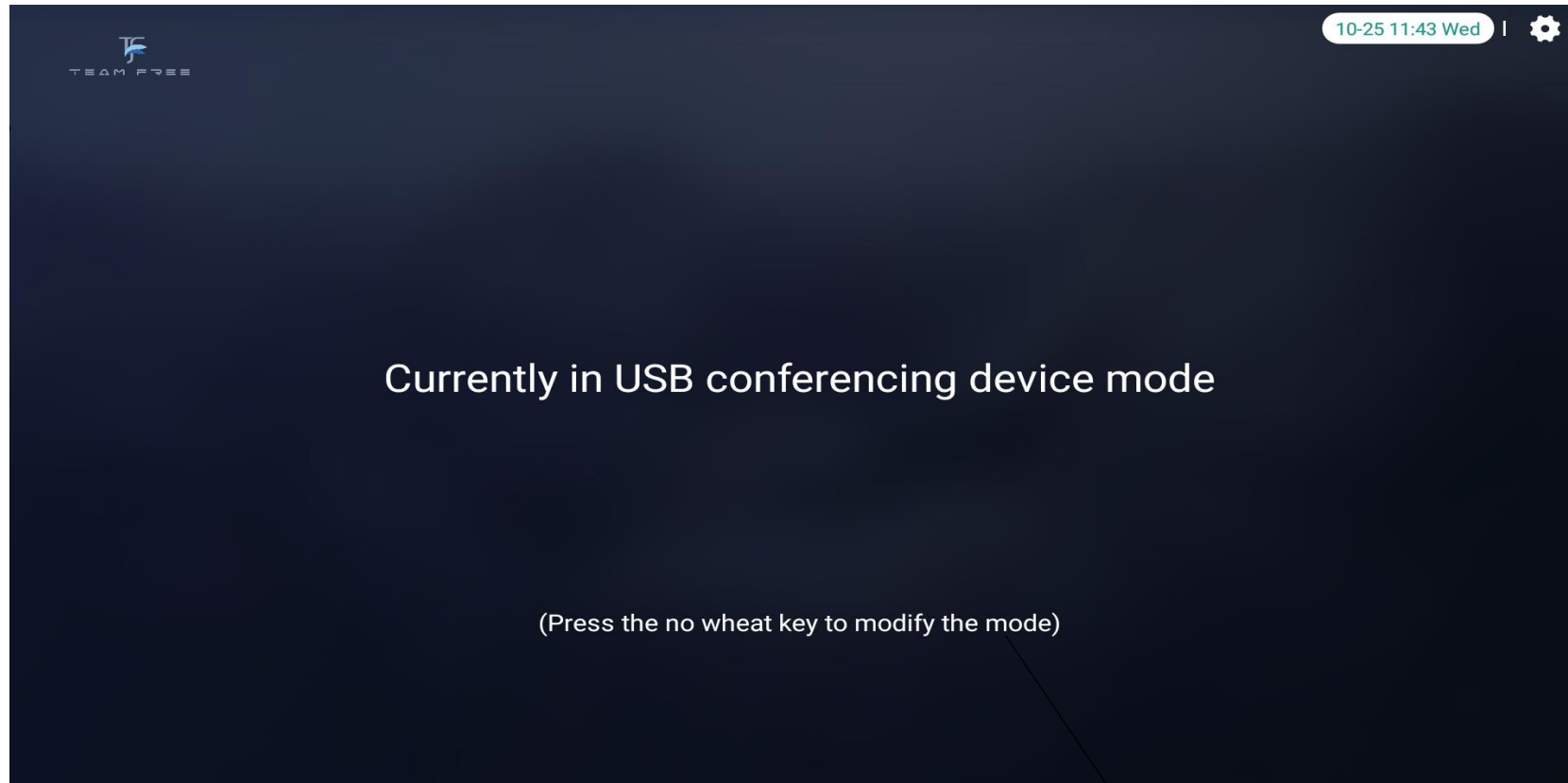

Press the mic on/off button
to switch to setup mode

Note: Press the mic on/off button switching to setup mode requires connecting HDMI-out to a TV or monitor with HDMI cable

USB version - USB device displays after driver-free installation on a Windows:

- 1 Right-click "My Computer" and select "Manage"

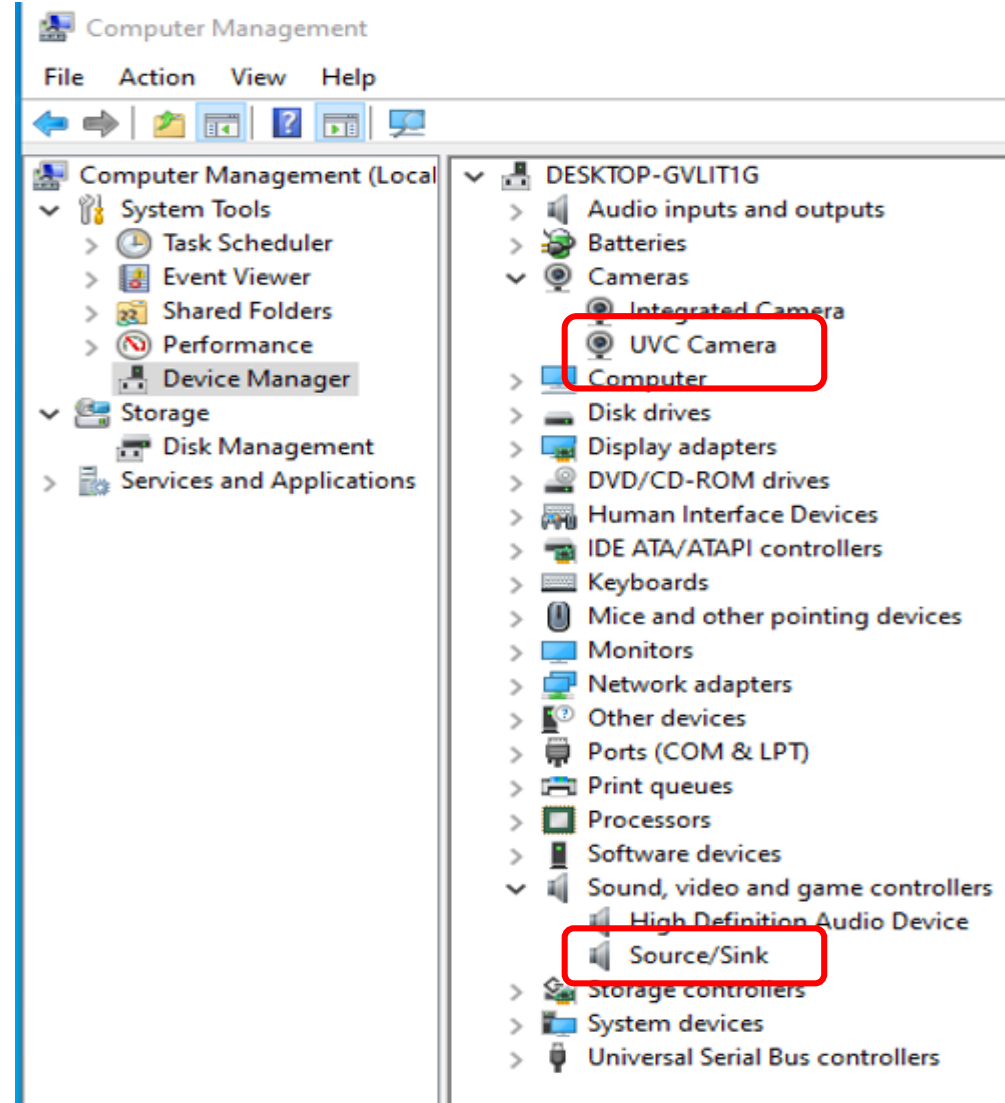
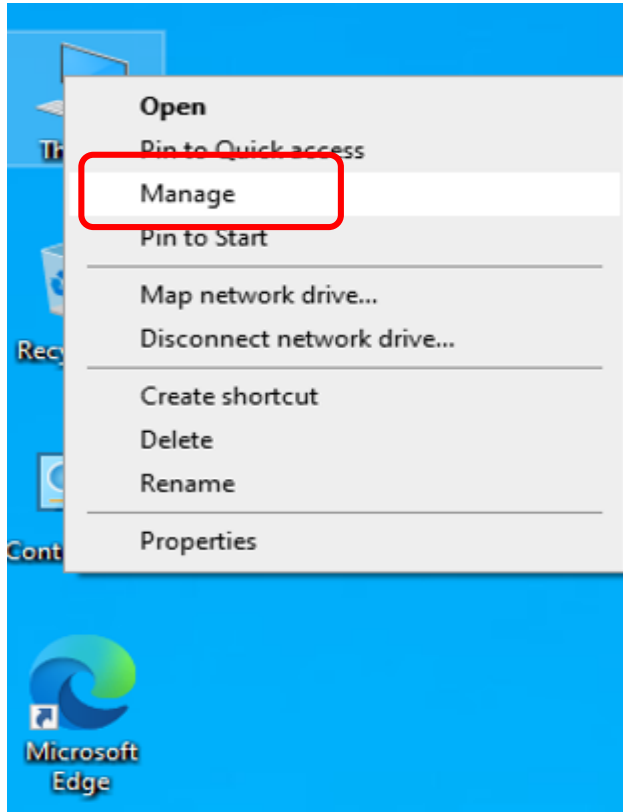

Note: If the device does not appear normally, you can power off and on again after connecting the USB. If it still cannot be recognized, please try changing the USB data cable.

USB version -- Testing camera:

- ② Search the "Camera" application in Windows applications to test the camera

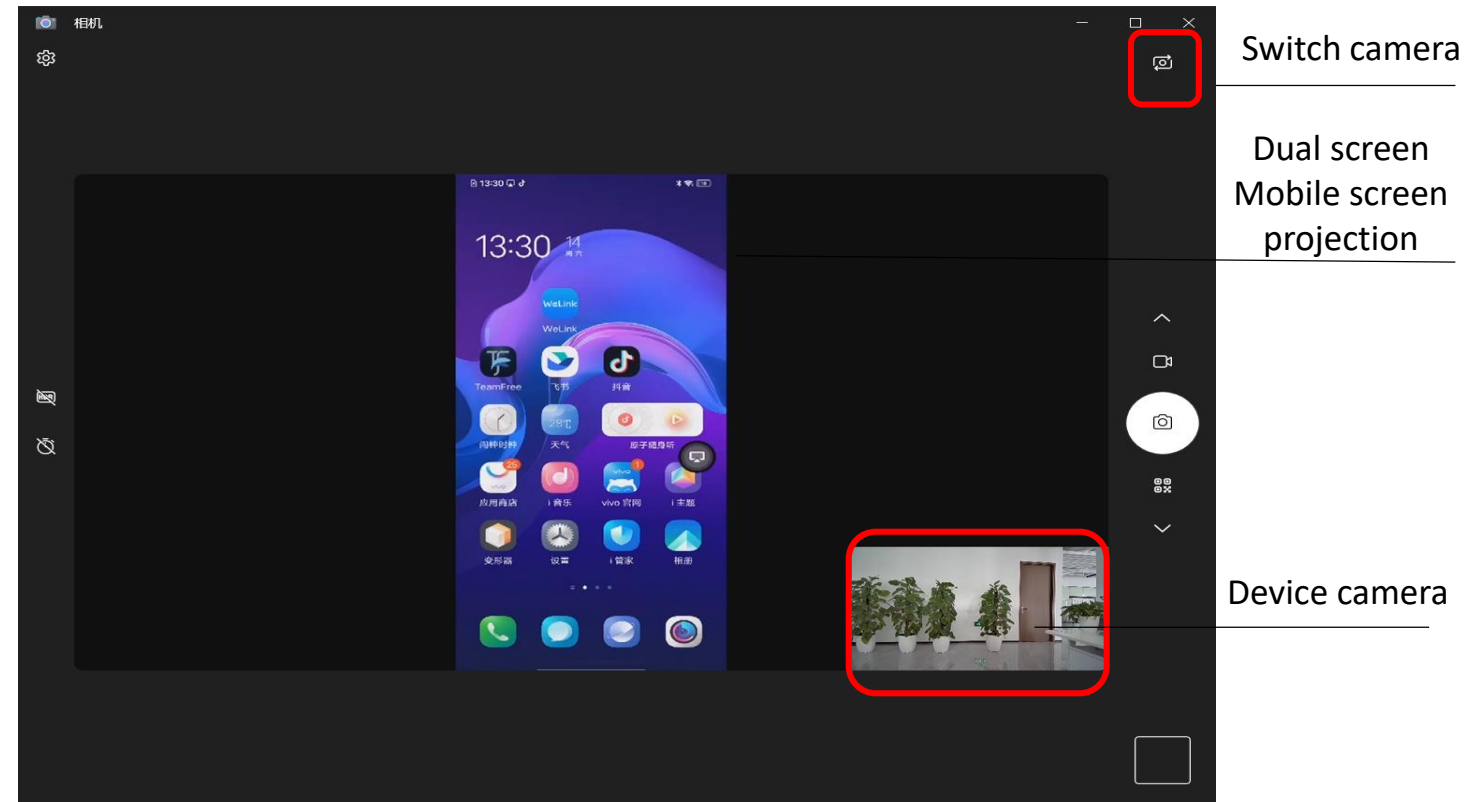
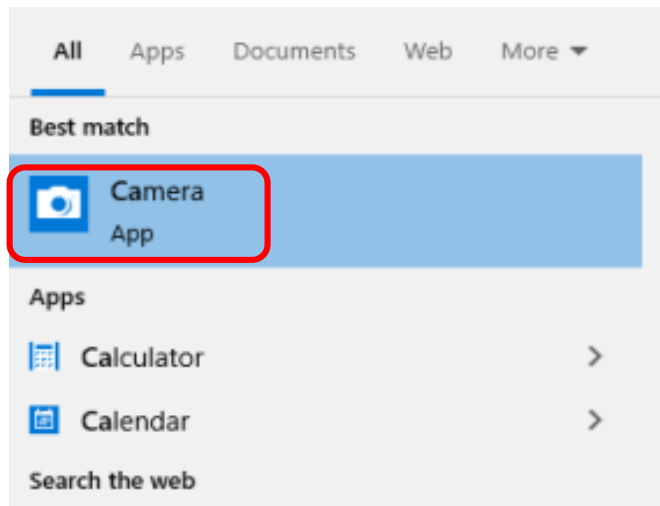

Note: The dual screen needs to be turned on using the APP remote control, HDMI、 wireless screen projection、 camera, and any two streaming videos can be used as the USB camera output screen.

USB version -- Testing microphone and speakers:

- ③ Right-click the speaker and select Sound Settings to test the speaker and microphone.

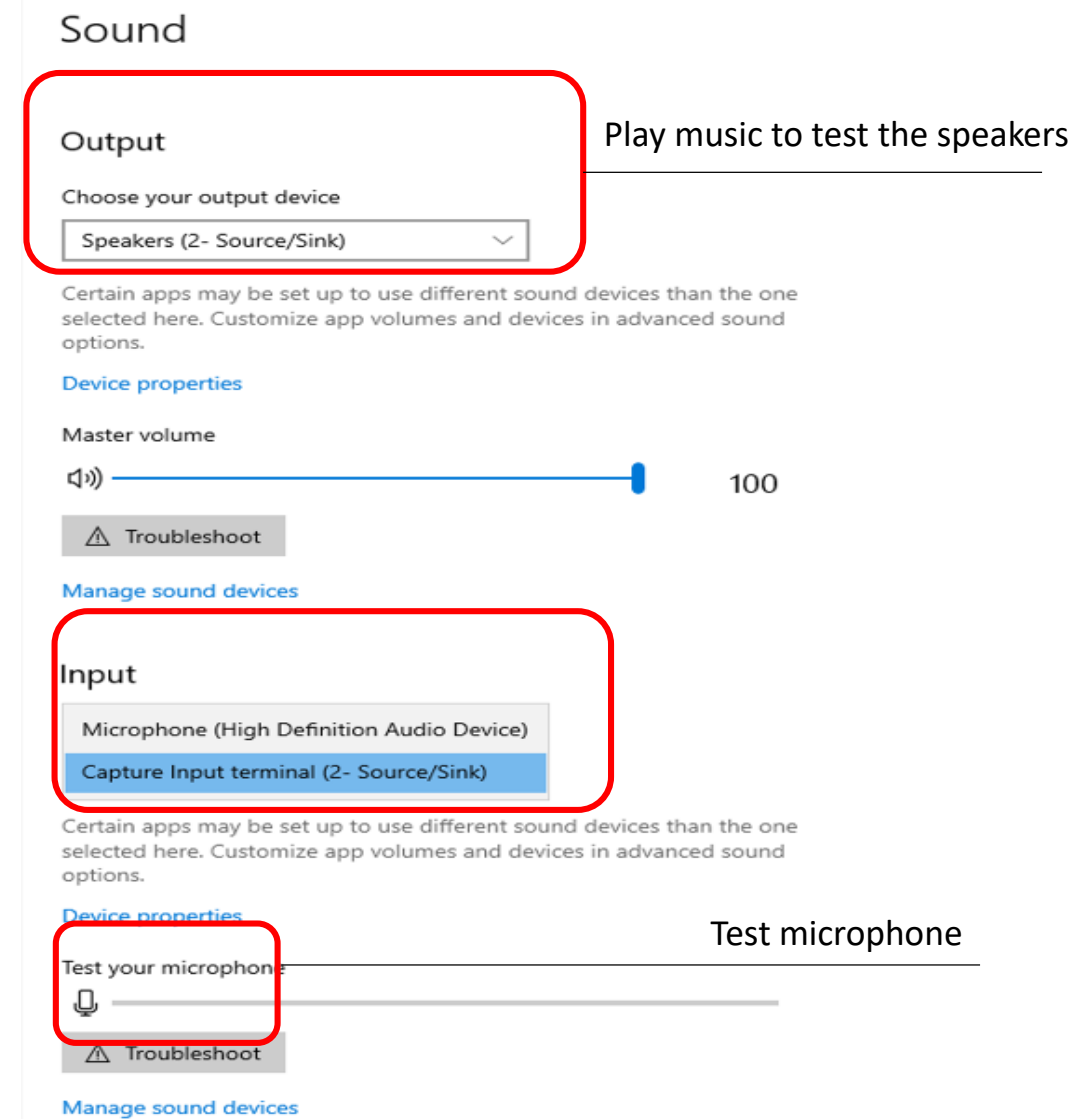
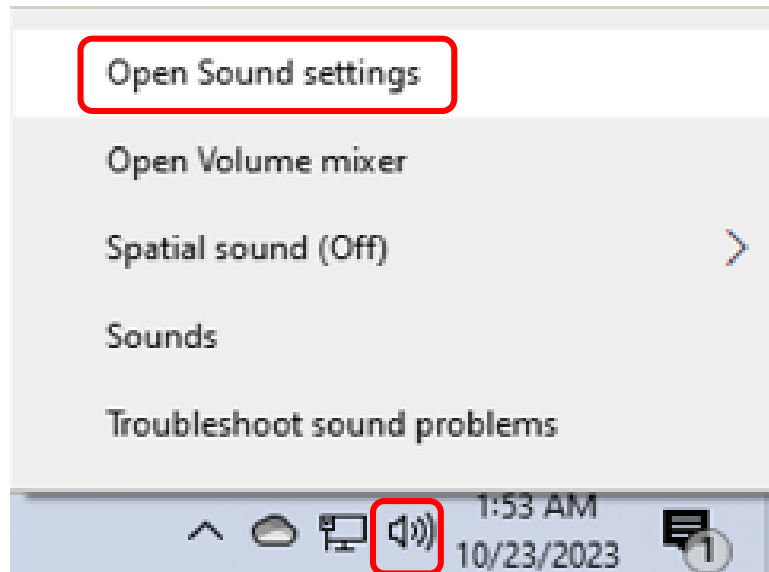

USB version -- Select camera, microphone and speaker in Zoom conference:

- 1 Right-click the speaker and select Open Sound Settings to test the speaker and microphone.

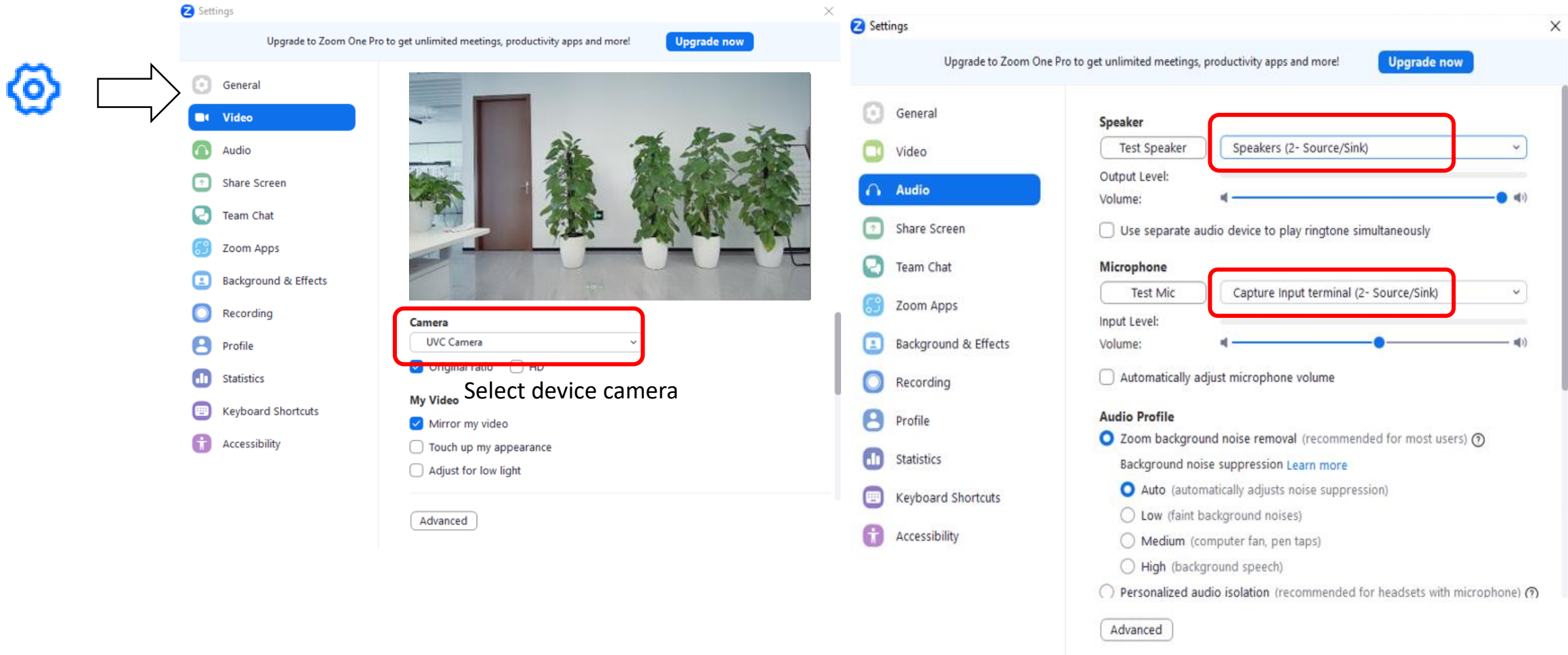

The image displays two side-by-side screenshots of the Zoom desktop application settings window. On the left, a blue gear icon and a white arrow point towards the 'Settings' window. The left screenshot shows the 'Video' settings tab. The 'Camera' dropdown menu is highlighted with a red box and contains the text 'UVC Camera'. Below this, the text 'Select device camera' is written. The right screenshot shows the 'Audio' settings tab. The 'Speaker' dropdown menu is highlighted with a red box and contains the text 'Speakers (2- Source/Sink)'. The 'Microphone' dropdown menu is also highlighted with a red box and contains the text 'Capture input terminal (2- Source/Sink)'. Both screenshots include a 'Test Speaker' button and a 'Test Mic' button. The 'Audio Profile' section on the right shows 'Zoom background noise removal' selected, with 'Auto' as the chosen option for noise suppression.

Settings

Upgrade to Zoom One Pro to get unlimited meetings, productivity apps and more! [Upgrade now](#)

Video

Camera

UVC Camera

My Video

☒ Mirror my video

☐ Touch up my appearance

☐ Adjust for low light

[Advanced](#)

Settings

Upgrade to Zoom One Pro to get unlimited meetings, productivity apps and more! [Upgrade now](#)

Audio

Speaker

Test Speaker **Speakers (2- Source/Sink)**

Output Level:

Volume:

☐ Use separate audio device to play ringtone simultaneously

Microphone

Test Mic **Capture input terminal (2- Source/Sink)**

Input Level:

Volume:

☐ Automatically adjust microphone volume

Audio Profile

☒ Zoom background noise removal (recommended for most users) [Learn more](#)

Background noise suppression [Learn more](#)

☒ Auto (automatically adjusts noise suppression)

☐ Low (faint background noises)

☐ Medium (computer fan, pen taps)

☐ High (background speech)

☐ Personalized audio isolation (recommended for headsets with microphone) [Learn more](#)

[Advanced](#)

USB version -- WeChat applet remote control device:

- ① WeChat applet connection (Search for Team Free remote control in WeChat's "Discover" page applet)
- ② Connect to the same wifi or the same LAN as the device and scan the current LAN device.



Discover USB device interface

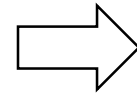

Note: Turning HDMI on and off when it is not connected to the device will cause the device to freeze, please wait patiently.

Modify device name

Camera on/off

HDMI on/off

Screencast on/off

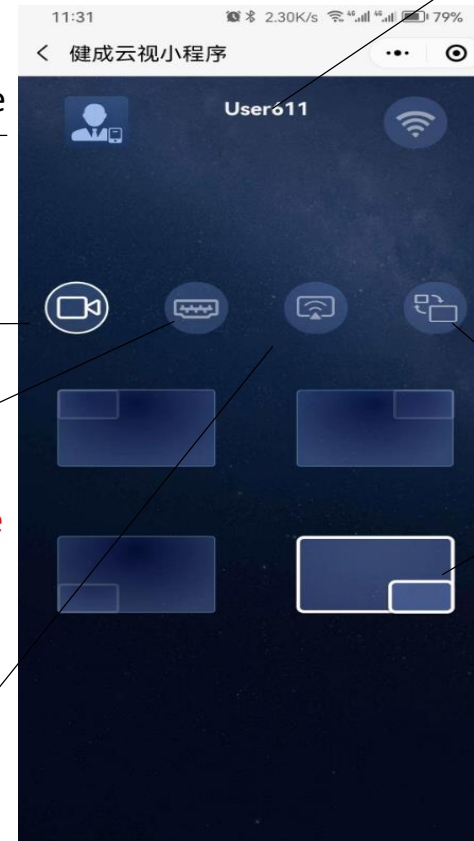

Remote control interface

Device name

Configure wifi connection for device

Note: Configuration errors will cause the device to be unable to connect to wifi

Switching position between large and small windows

Dual stream setting small window position

- Support upper left, lower left, upper right, lower right

Note: It must be on the same LAN/access to the same wifi as the connected device. After setting up the device wifi, you need to reconnect the phone to the set wifi.

USB version -- Mobile App remote control :

❶ Mobile APP remote control device (download teamfree from google App market)

- 1) The mobile APP needs to be in the same LAN or wifi as the device

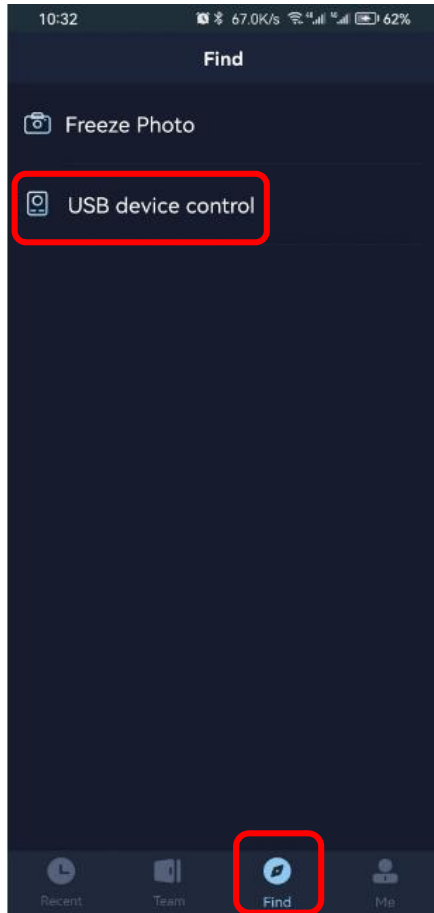

USB device control

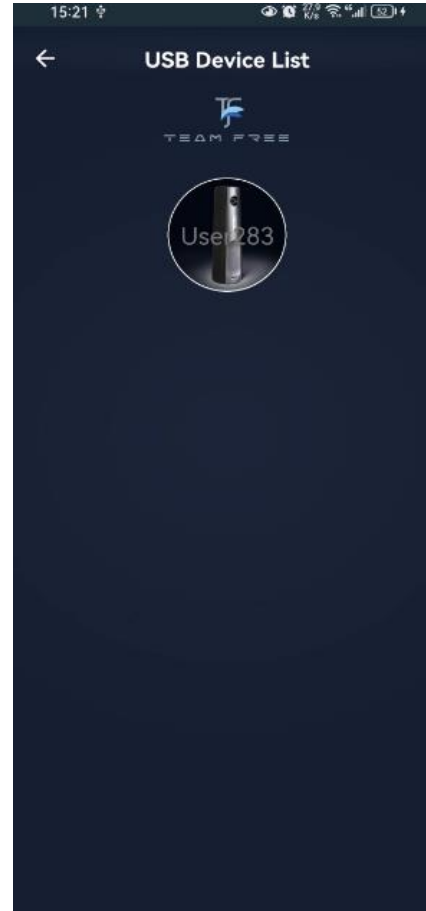
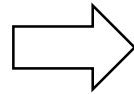

Scan USB devices

Modify device name

Camera on/off

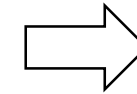

HDMI on/off

Note: Turning HDMI on and off when it is not connected to the device will cause the device to freeze, please wait patiently.

Screencast on/off



Device name

Send wifi configuration to device

Switch size window position

Set the position of the small window

- Support upper left, lower left, upper right, lower right

USB device control

Note: The network where the mobile APP is located needs to be in the same LAN as the device or connected to the same wifi.

USB version – Setup mode Device connection:

1 Power Connection

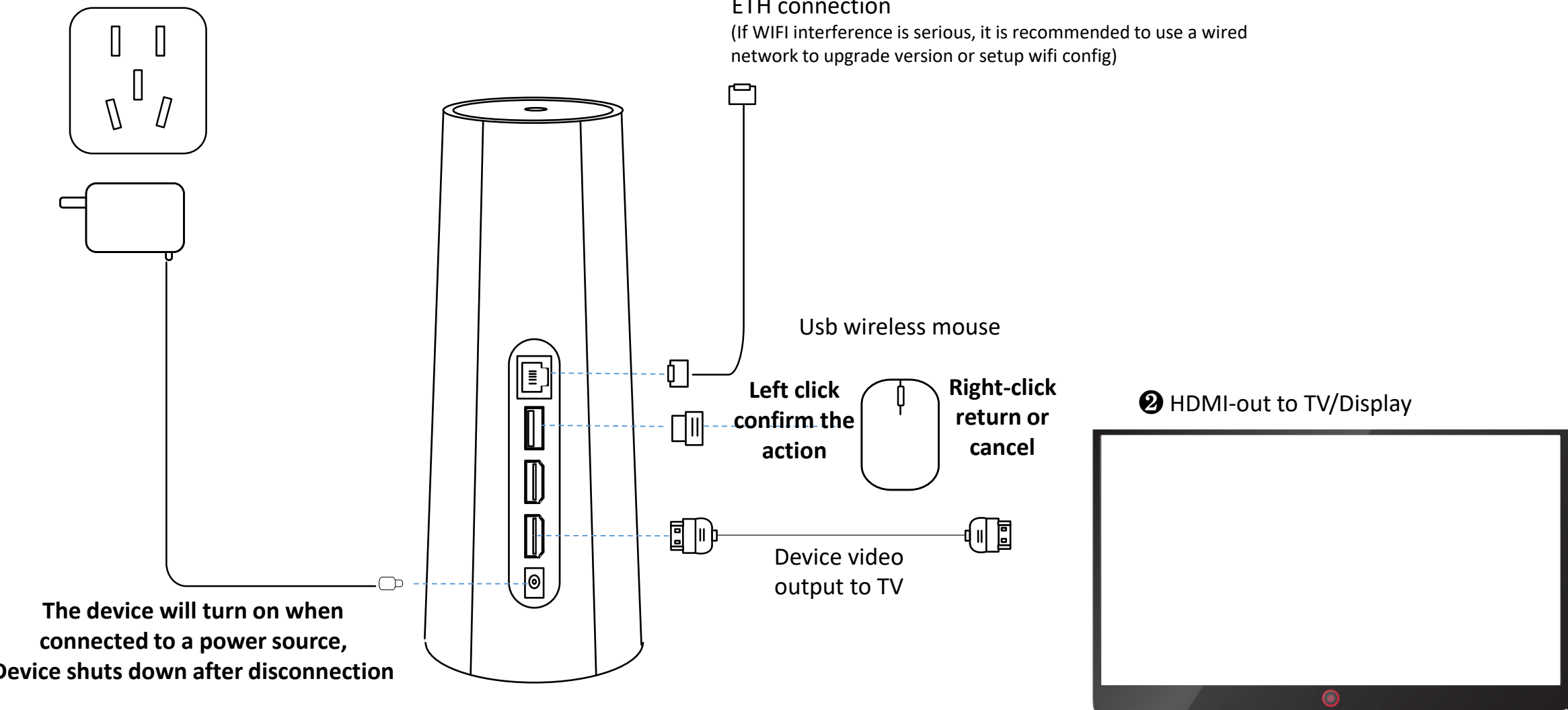

Note: In setup mode, HDMI-out needs to be connected to the TV. At this time, the USB interface can be connected to the mouse for device operation.

USB version -- Switch to Setup mode

- ① Press mic on/off button to switch

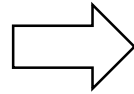

Entering setup mode requires connecting HDMI-out to a TV or monitor with HDMI cable.

switch menu

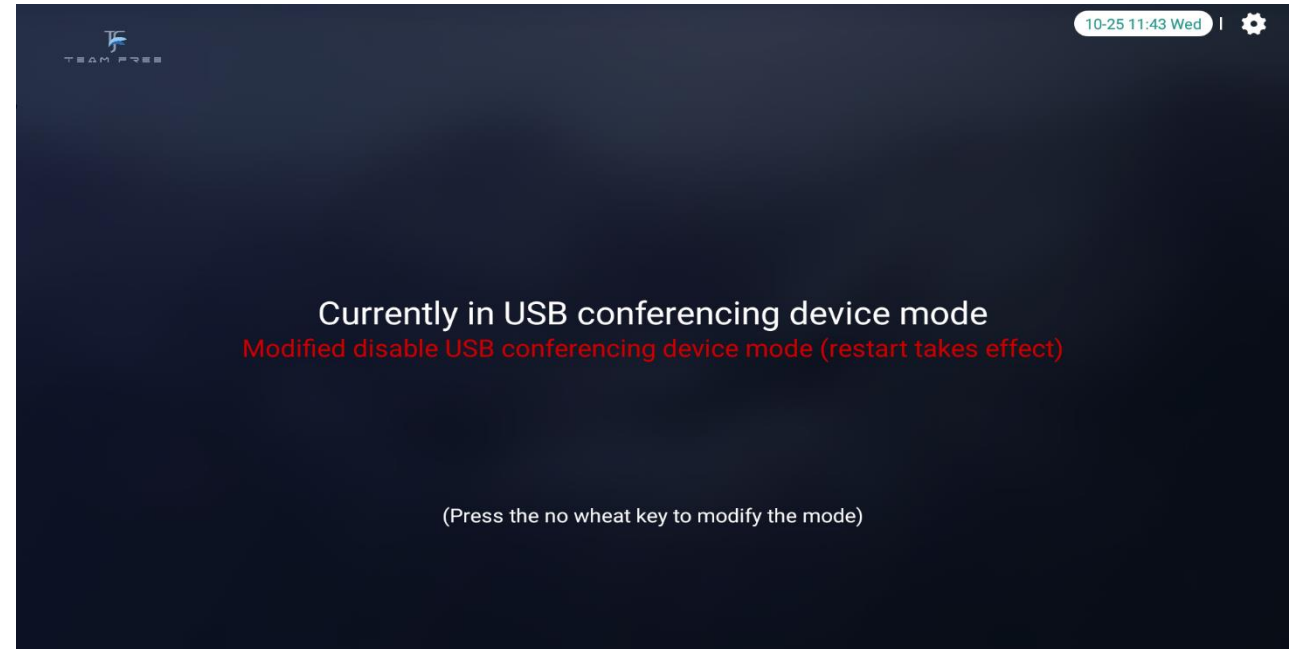

- ② Power off and on again and restart the device

Note: Press the mic on/off button switching to setting mode requires connecting HDMI-out to a TV or monitor with HDMI cable

USB version -- Setup mode

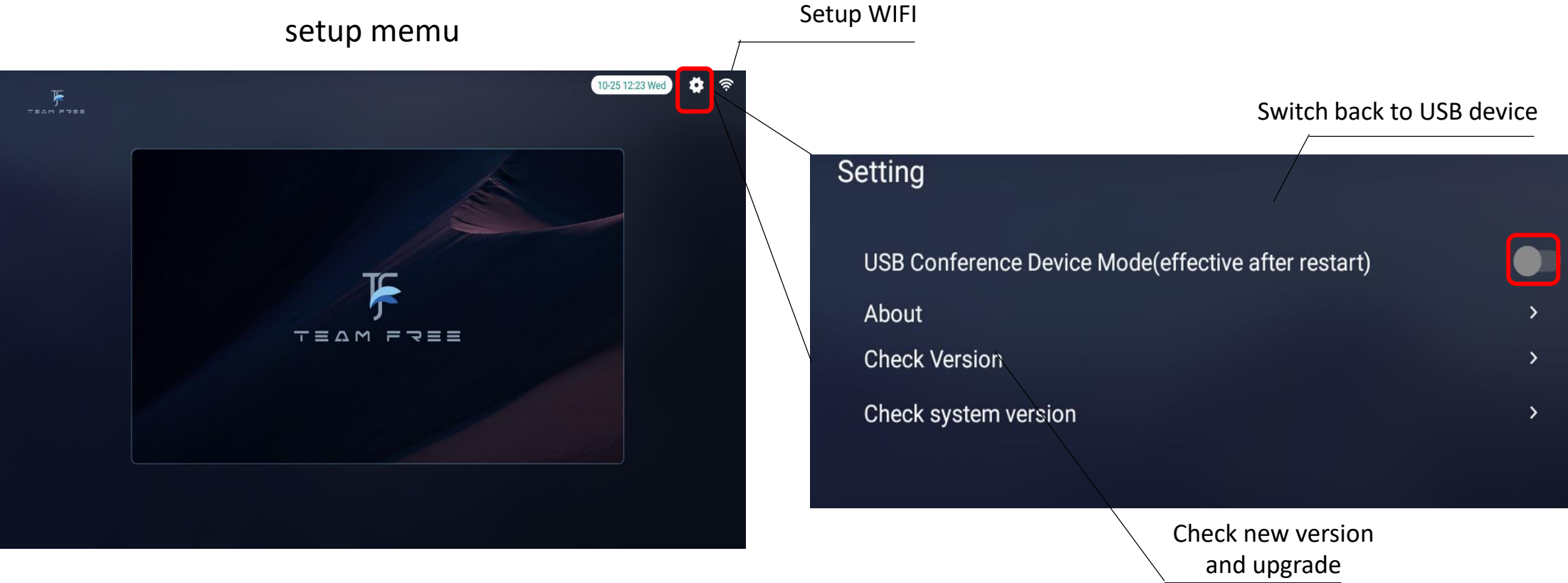

Note: Returning to USB device mode from setup mode requires restarting the device.

FCC Statement

This equipment has been tested and found to comply with the limits for a Class B digital device, pursuant to part 15 of the FCC Rules. These limits are designed to provide reasonable protection against harmful interference in a residential installation. This equipment generates, uses and can radiate radio frequency energy and, if not installed and used in accordance with the instructions, may cause harmful interference to radio communications. However, there is no guarantee that interference will not occur in a particular installation. If this equipment does cause harmful interference to radio or television reception, which can be determined by turning the equipment off and on, the user is encouraged to try to correct the interference by one or more of the following measures:

- Reorient or relocate the receiving antenna.
- Increase the separation between the equipment and receiver.
- Connect the equipment into an outlet on a circuit different from that to which the receiver is connected.
- Consult the dealer or an experienced radio/TV technician for help.

This device complies with part 15 of the FCC Rules. Operation is subject to the following two conditions: (1) This device may not cause harmful interference, and (2) this device must accept any interference received, including interference that may cause undesired operation.

The antenna(s) used for this transmitter must be installed to provide a separation distance of at least 20 cm from all persons.

Caution:

Any changes or modifications not expressly approved by the party responsible for compliance could void the user's authority to operate the equipment.

Shenzhen Jiancheng Yunshi Technology Co.,Ltd.

Address: Room 1701, Building 4, Bangyan Green Valley Factory, No. 98 Zhihe Road,
Dakang Community, Yuanshan Street, Longgang District, Shenzhen City

Email: service@giantsee.com

Website: www.team-free.com